



Sliding door system for overlay doors:
TopLine 22

Technik für Möbel

Hettich

Slide it. Love it.

Everyone does it: Slide it. Love it.

People like to keep it simple. On their tablet PCs. On their smartphones. The revolutionary aesthetic appeal of virtual sliding fascinates millions: gentle, flowing movement, simply at the touch of a finger.

But sliding in the real world is captivating more and more people: cars that provide real practical value come with a sliding door; a sliding sunroof creates a sensation of openness and space, and at home there we are sliding panel curtains and doors, whether as room dividers or on furniture.

The trend towards sliding is also opening new doors for you too: Hettich gives you sliding door systems that go perfectly with your furniture ideas. For bedroom, living room, office and kitchen furniture.

Are you open to a new love? Welcome to Hettich.



Ergonomics

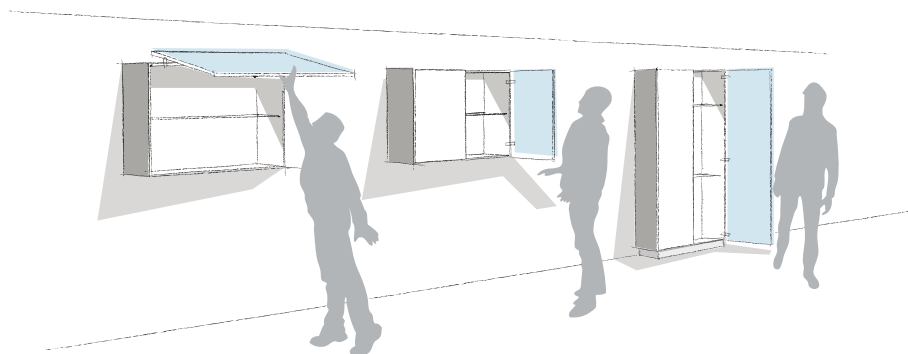

Always in reach. Never in the way.

In terms of ergonomics and convenience, sliding doors are a cut above any other door system. That's clear to see in everyday use: open sliding doors don't get in the way where space is at a premium. Open doors on wall units are not likely to leave you injured. Sliding doors are also easy to open without stretching or dodging out the way.

Design

Unadulterated form. Distinctive surfaces.

Sliding doors provide the key to picking up on modern, spacious interior design and cleverly carry it through in furniture. Because large surface doors, particularly with flush fitted sliding door systems, are the ideal creative element for purist interior design.

Hettich sliding door systems impress with narrow reveals that hardly detract from the homogeneous look of furniture fronts. Only a few reveals are visible on large format fronts anyway; elegant fascias reduce the number of reveals to a minimum.

Easy precision adjustment provides superb finished results with perfect gap alignment.

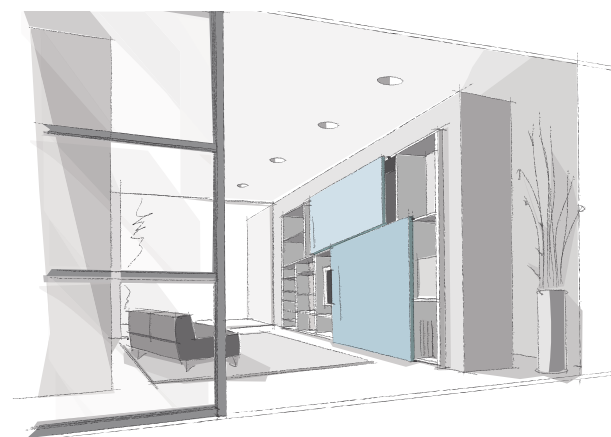

Functionality

Easy to begin with. Then quiet.

Sliding doors are particularly good at meeting the demands users place on cabinet doors today: they are easy to open and close. The ergonomic benefit of linear door movement (see page 3) is optimised further still by low opening forces. Convenient Silent System closes the sliding door quietly and gently.

Altogether, Hettich sliding door systems leave no margin of doubt with reliable quality, superb smooth gliding action and long life.

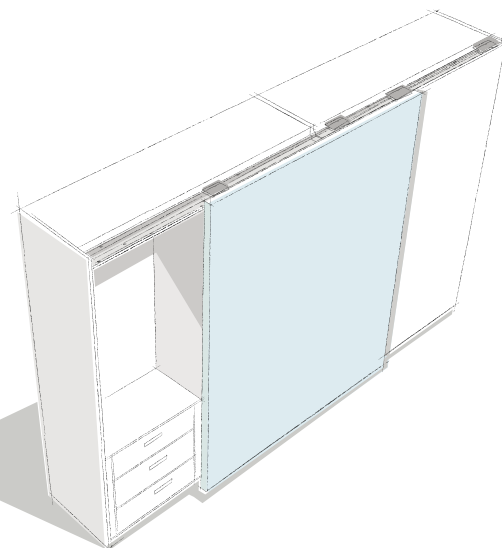

Mission: better cabinets!



Cabinets for life. With Hettich sliding door systems.

Sliding doors provide all manner of convenience and practical benefits for everyday living, such as in wardrobes. A sliding door cabinet takes up less space than a hinged door cabinet because the doors don't intrude into the room when they are open. They don't cast a shadow in the room or on cabinet contents either. Sliding doors provide fast, barrier-free access to the cabinet interior.

Overlay doors also come with the advantage that fittings and profiles are mounted on the outside without invading storage space.

The original – re-interpreted.

Many industrially manufactured sliding doors weighing up to 50 kg have one thing in common: the TopLine 22 sliding door system from Hettich.

The tried and proven technology behind TopLine 22 has impressed for many years with incredibly smooth running action and stability. Optional Silent Systems provide even greater practical convenience.

It is easy to install and geared to the needs of industry. And the wide range of accessories gives you even more ways to make a mark of distinction in marketing your furniture. Now as ever, TopLine 22 sets the standards in large format cabinets, such as in bedroom wardrobes.



Technical details in brief *)

- ▶ 2-track, top running sliding door system
- ▶ Overlay door position
- ▶ Door weight up to 50 kg
- ▶ Door height up to 2500 mm
- ▶ Door width from 500 to 1500 mm
- ▶ Door thickness up to 25 mm
- ▶ Silent System optionally in closing, opening and colliding direction

*) Tested to DIN EN 15706

Top running sliding door system

- ▶ TopLine 22
- ▶ Convenience



Smooth, quiet running action even for heavy doors, plus numerous Silent System options: TopLine 22 impresses with a high level of convenience for large surface sliding doors.



Ball bearing rollers for extremely smooth running action.



Silent System evenly and softly closes any sliding door.



Optional Silent System in closing, opening and colliding direction.



Silent System: The door easily opens with very little effort.

Top running sliding door system

► TopLine 22

► Design



More strength, more options: TopLine 22 takes every effort out of moving large, heavy doors weighing up to 50 kg in many different designs and materials. Incidentally: you can also upgrade the design and function of existing cabinet constructions with TopLine 22.



Large door surfaces with a feel of luxury and fewer reveals for an overall look of harmony.



Silent System can also be mounted behind the profile so as not to interfere with the cabinet's overall appearance.



For luxurious 3-door cabinet constructions: Silent System soft closing for the centre door.

Sliding door systems

Quality criteria

Quality that meets all the demands

The quality of Hettich sliding door systems is subject to a continuous process of monitoring. Hettich reliably meets the quality standards of specific markets and industries. The illustrations below show examples of some of Hettich's quality tests.

- ▶ Endurance test over 40,000 cycles
- ▶ Closing test with a pulling force of 4 kg
- ▶ Lift out test at 250 N
- ▶ Load test in horizontal direction at 250 N

Endurance test

Endurance test: the door is required to withstand a specific number of opening and closing cycles at a defined speed.

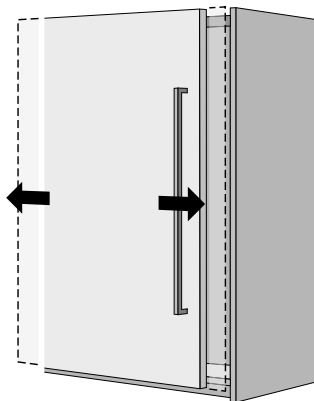

Lift off guard

The door is pulled up and forwards at an angle with a defined force and must not come off or fall out of the carcass.

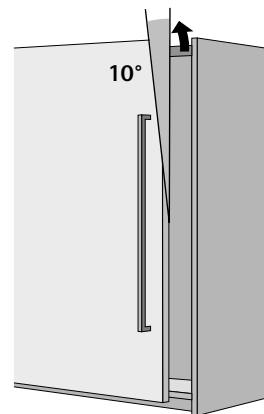

Closing test

The door must withstand a specific number of closing cycles under a defined tensile load.

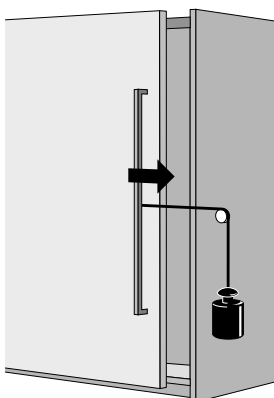

Horizontal safety test

Pressure is applied to the middle of the door with a defined force. The door must not come off or fall out of the carcass.

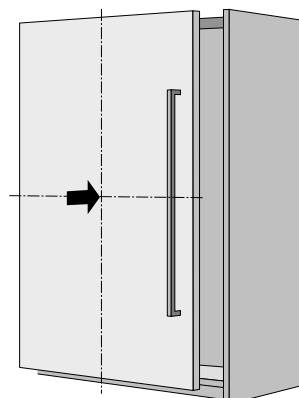

Tested to DIN EN 15706



Top running sliding door system

► TopLine 22

► System components/Silent System under the profile

Set

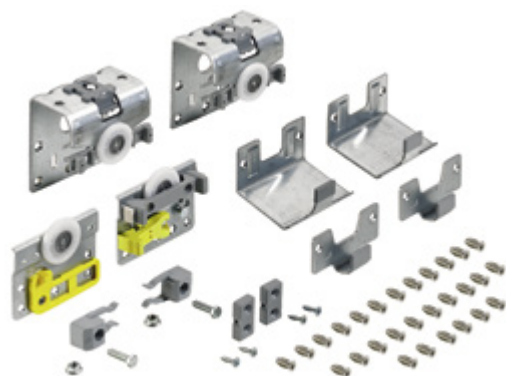

- Set contains all the parts required for an entire cabinet
- Three-door upgrade set contains all parts for an additional rear door

| Door centre distance (EB) mm | Door thickness in mm | Quantity for 2 doors | Quantity for 3 doors | Order no. | PU |
|------------------------------|----------------------|----------------------|----------------------|------------------|-------|
| 29 | 19 max. | 1 | 1 | 9 181 751 | 1 set |
| 36 | 25 max. | 1 | 1 | 9 181 752 | 1 set |
| Upgrade set for 3 doors | | | 1 | 9 181 668 | 1 set |

Running component for front most door



- Galvanised steel
- Plastic rollers with steel ball bearing
- Tool-less lift off guard

| Door centre distance (EB) in mm | Door thickness in mm | Quantity for 2 doors | Quantity for 3 doors | Order no. | PU |
|---------------------------------|----------------------|----------------------|----------------------|------------------|----|
| 29 | 19 max. | 2 | 2 | 9 153 035 | 50 |
| 36 | 25 max. | 2 | 2 | 9 153 032 | 50 |

Running component for rear most door



- Galvanised steel
- Plastic rollers with steel ball bearing
- Tool-less lift off guard with integrated Silent System activator

| | Door offset in mm | Quantity for 2 doors | Quantity for 3 doors | Order no. | PU |
|--|-------------------|----------------------|----------------------|------------------|-----|
| | 80 | 1 | 2 | 9 160 317 | 200 |

Running component for rear most door without stop pin



- Galvanised steel
- Plastic rollers with steel ball bearing
- Tool-less lift off guard

| Quantity for 2 doors | Quantity for 3 doors | Order no. | PU |
|----------------------|----------------------|------------------|-----|
| 1 | 2 | 9 007 350 | 200 |

Top running sliding door system

- ▶ TopLine 22
- ▶ System components/Silent System under the profile

Runner profile for mounting in front of top panel

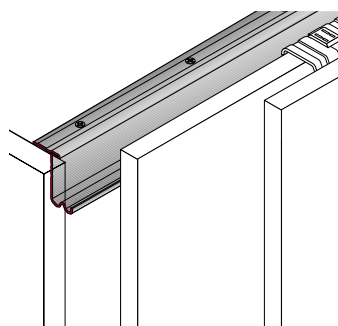
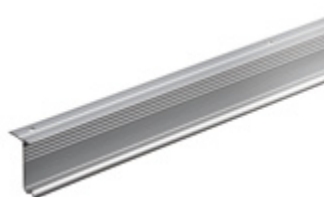

- ▶ Door running in front of top panel
- ▶ Available in steel and aluminium
- ▶ Customised drill holes and premounted end stops on request

| Material | Finish | Length | Quantity | Order no. | Minimum quantity |
|-----------|------------------|------------|----------|-----------|------------------|
| Steel | galvanised | individual | 1 | LA 2233 | 100 |
| Steel | silver, coated | individual | 1 | LA 2233 | 100 |
| Aluminium | bright | individual | 1 | LA 1233 | 100 |
| Aluminium | silver, anodised | individual | 1 | LA 1233 | 100 |

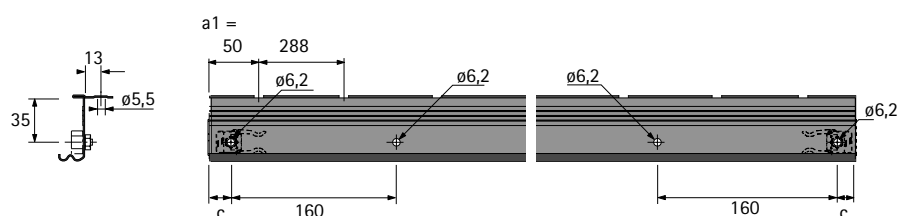

Cover profile

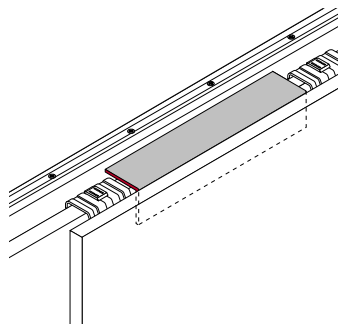

- ▶ Plastic, grey

| Material | Colour | Length | Quantity | Order no. | Minimum quantity |
|----------|--------|------------|----------|-----------|------------------|
| Plastic | grey | individual | 1 | LA 1341 | 100 |

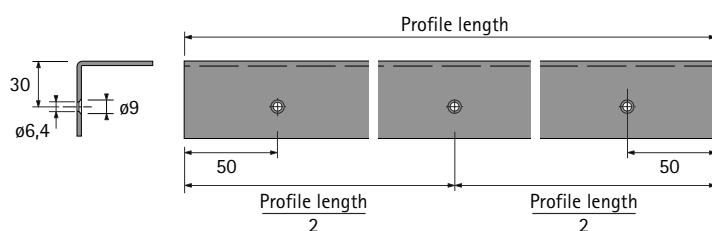

Top running sliding door system

- ▶ TopLine 22
- ▶ System components/Silent System under the profile

Silent System soft closing set



- ▶ Quietly and gently closing sliding doors
- ▶ Low opening forces for easy door movement
- ▶ 3-door: soft closing for rear most doors

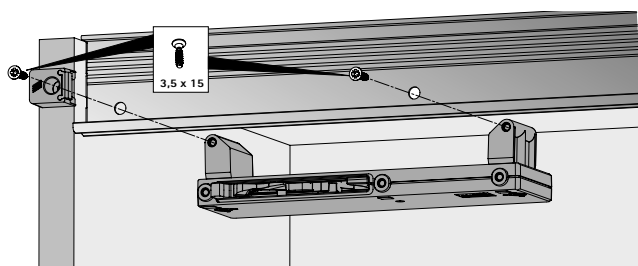

| Door centre distance (EB) in mm | Door thickness in mm | Quantity for 2 doors | Quantity for 3 doors | Order no. | PU |
|---------------------------------|----------------------|----------------------|----------------------|------------------|-------|
| 29 | 19 max. | 1 | | 9 161 026 | 1 set |
| 36 | 25 max. | 1 | | 9 161 028 | 1 set |
| | | | 1 | 9 169 635 | 1 set |

Silent System soft closing set



- ▶ Centre door of 3-door cabinets closes quietly and gently
- ▶ Low opening forces for easy door movement
- ▶ Centre door can be opened from both sides
- ▶ Concealed installation on top panel

| | Quantity for 3 doors | Order no. | PU |
|--|----------------------|------------------|----|
| | 1 | 9 140 438 | 1 |

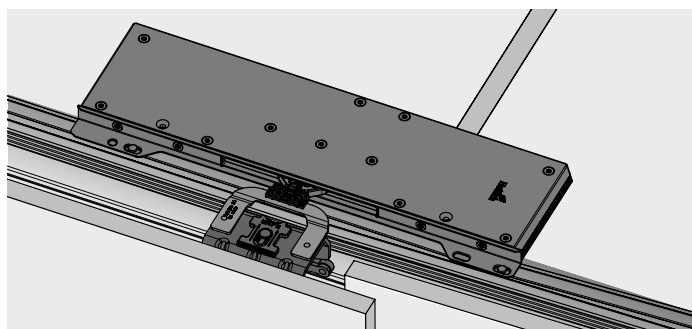

Top running sliding door system

► TopLine 22

► System components/Silent System under the profile

Silent System soft opening set



- Sliding doors open quietly and gently
- Little effort required for easy door movement
- 3-door: soft opening for rear most doors

| Quantity for 2 doors | Quantity for 3 doors | Order no. | PU |
|----------------------|----------------------|------------------|----|
| 1 | 1 | 9 169 618 | 1 |

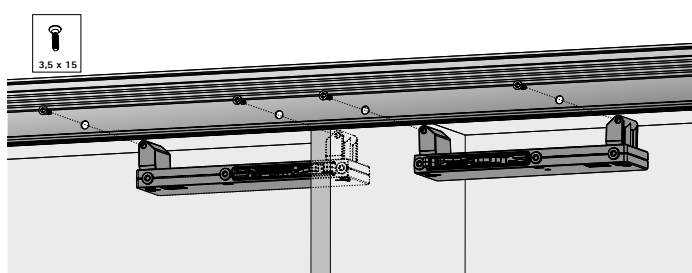

Set Silent System soft colliding set



- Gentle opening and colliding doors
- Easily added to outer running component on rear most door
- 3-door: rear most doors each fitted with a soft colliding element

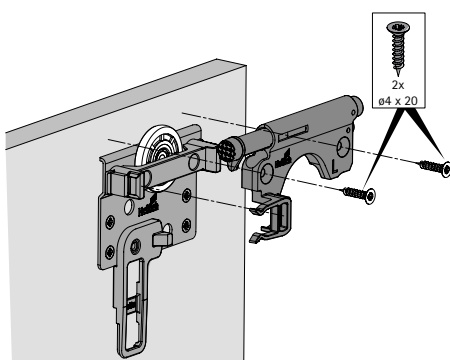

| Version | Door weight | Quantity for 2 doors | Quantity for 3 doors | Order no. | PU |
|---------|-------------|----------------------|----------------------|------------------|----|
| left | light | 1 or right | 1 + right | 9 156 208 | 1 |
| right | light | 1 or left | 1 + left | 9 156 209 | 1 |
| left | heavy | 1 or right | 1 + right | 9 156 627 | 1 |
| right | heavy | 1 or left | 1 + left | 9 156 628 | 1 |

Top running sliding door system

- ▶ TopLine 22
- ▶ System components/Silent System under the profile

Runner profile end stop



- ▶ Plastic, grey
- ▶ End stop with self closing feature for applications without Silent System
- ▶ Attachment with M5 x 20 hexagon head screw and M5 hexagon nut with washer

| Quantity for 2 doors | Quantity for 3 doors | Order no. | PU |
|----------------------|----------------------|------------------|------|
| 2 | 2 | 9 150 145 | 1000 |

Support block



- ▶ Plastic, grey
- ▶ Attachment with 3.5 x 16mm countersunk screws

| Quantity for 2 doors | Quantity for 3 doors | Order no. | PU |
|----------------------|----------------------|------------------|-----|
| 2 | 2 | 9 118 201 | 500 |

Centre stop



- ▶ Plastic, grey
- ▶ For front most door
- ▶ Attachment with 3.5 x 25mm countersunk screws

| | Quantity for 3 doors | Order no. | PU |
|--|----------------------|------------------|-----|
| | 1 | 1 078 311 | 500 |

Guide profile end stop



- ▶ Plastic, grey
- ▶ Attachment with 4.5 x 25 panhead wood screws

| Quantity for 2 doors | Quantity for 3 doors | Order no. | PU |
|----------------------|----------------------|------------------|------|
| 2 | 2 | 9 112 511 | 1000 |

Top running sliding door system

► TopLine 22

► System components/Silent System under the profile

Attachment of running and guide components



- 6.3 x 14 direct fixing screws
- For attaching running and guide components

| Quantity for 2 doors | Quantity for 3 doors | Order no. | PU |
|----------------------|----------------------|------------------|------|
| 28 | 42 | 1 005 568 | 1000 |

Attachment of runner profile end stop



- M5 x 20 hexagon head screw
- M5 hexagon nut with washer
- For attaching end stops in the runner profile

| | | Quantity for 2 doors | Quantity for 3 doors | Order no. | PU |
|--|-------|----------------------|----------------------|------------------|------|
| | Screw | 2 | 2 | 9 153 060 | 1000 |
| | Nut | 2 | 2 | 3 133 245 | 1000 |

Attachment of support block



- 3.5 x 16 countersunk screw
- For attaching support block to carcass

| Quantity for 2 doors | Quantity for 3 doors | Order no. | PU |
|----------------------|----------------------|------------------|------|
| 4 | 4 | 1 990 022 | 1000 |

Attachment of centre stop



- 3.5 x 25 countersunk screw
- For attaching centre stop in the runner profile

| | Quantity for 3 doors | Order no. | PU |
|--|----------------------|------------------|------|
| | 2 | 1 993 557 | 1000 |

Attachment of guide profile end stop



- 4.5 x 25 panhead wood screw
- For attaching end stop in the guide profile

| Quantity for 2 doors | Quantity for 3 doors | Order no. | PU |
|----------------------|----------------------|------------------|------|
| 2 | 2 | 1 997 315 | 1000 |

Top running sliding door system

- TopLine 22
- Fitting situation

2-door, 80 mm door offset without Silent System

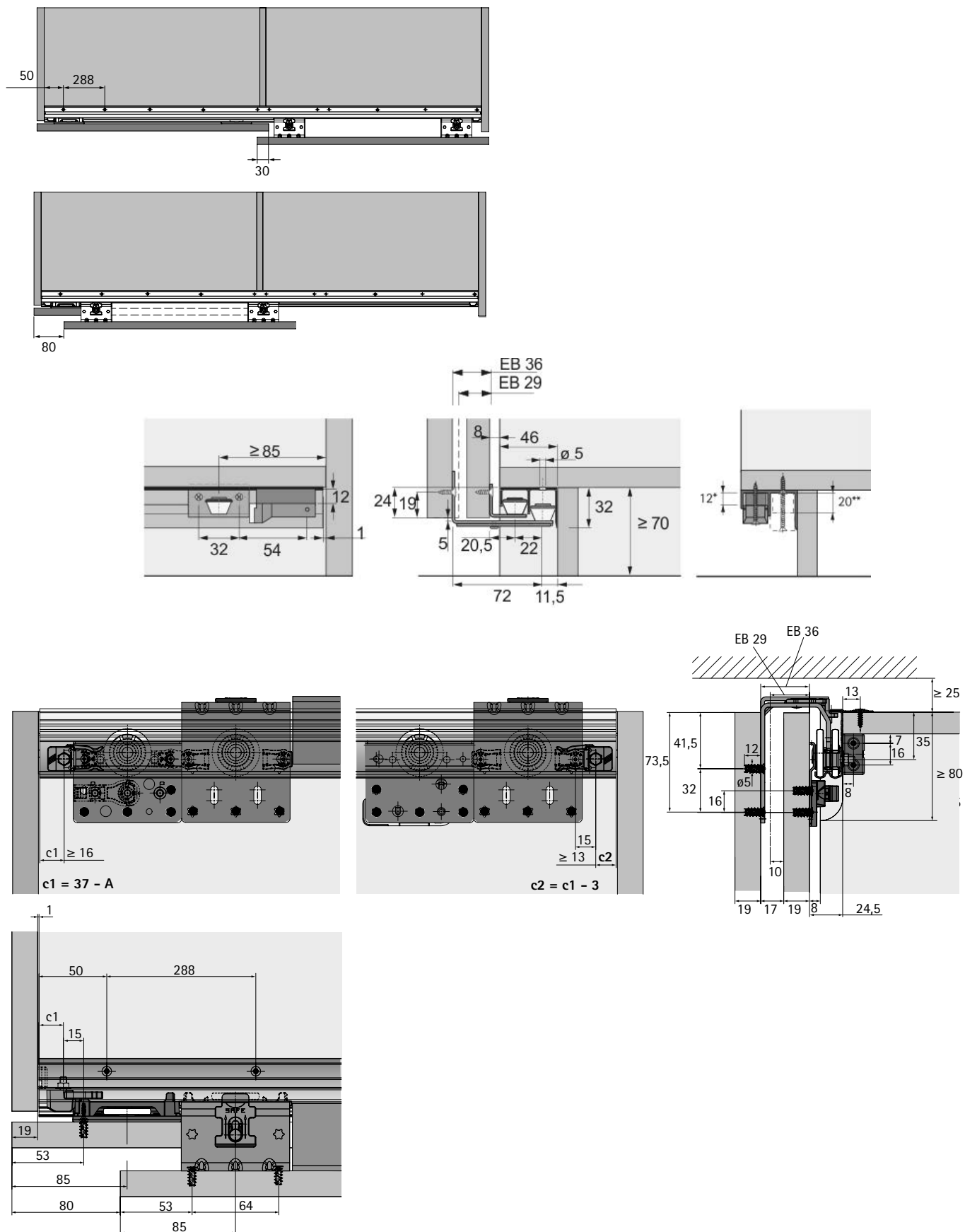

Top running sliding door system

- TopLine 22
- Fitting situation

3-door, 80 mm door offset without Silent System

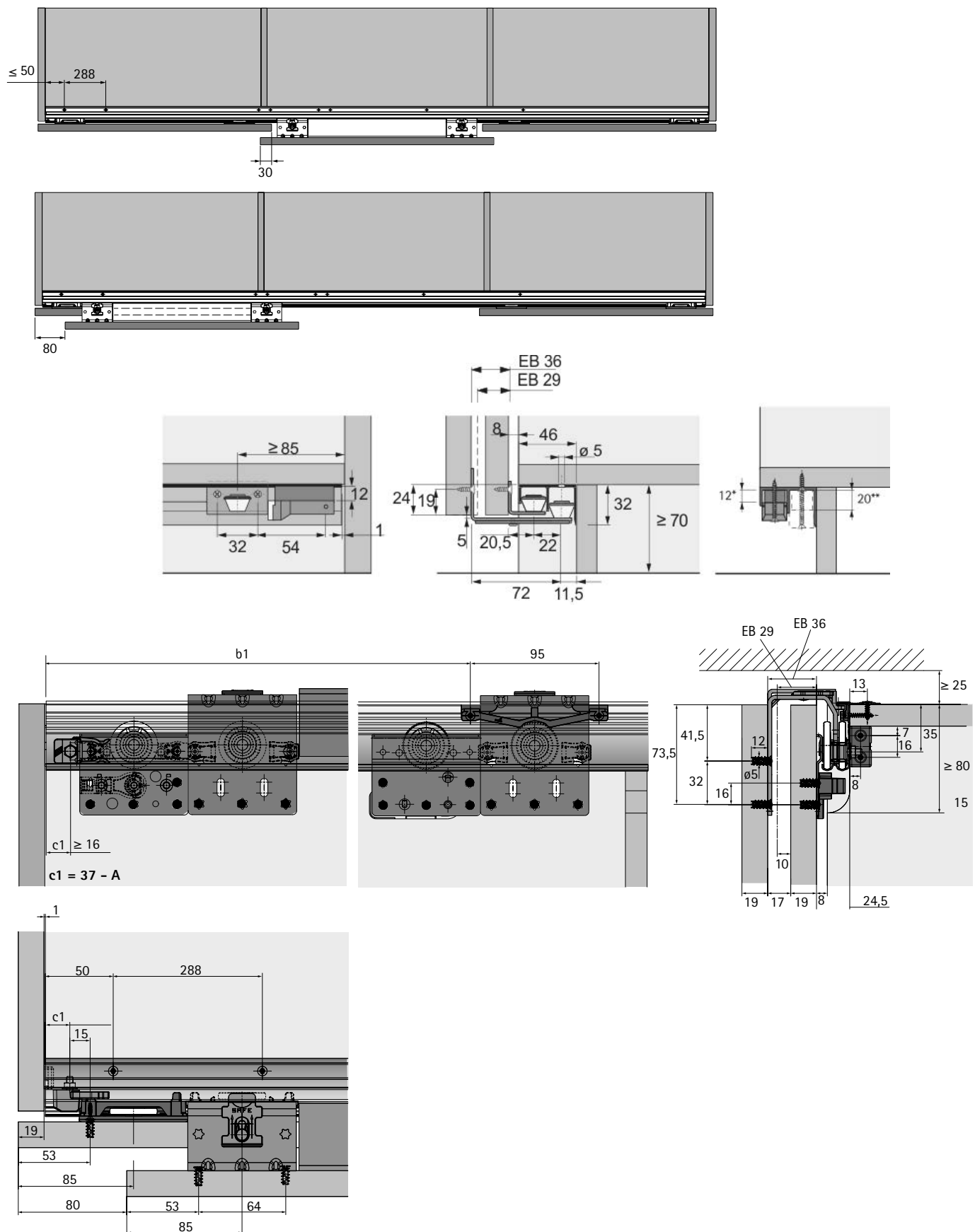

Top running sliding door system

- ▶ TopLine 22
- ▶ Fitting situation

2-door, 80 mm door offset with Silent System

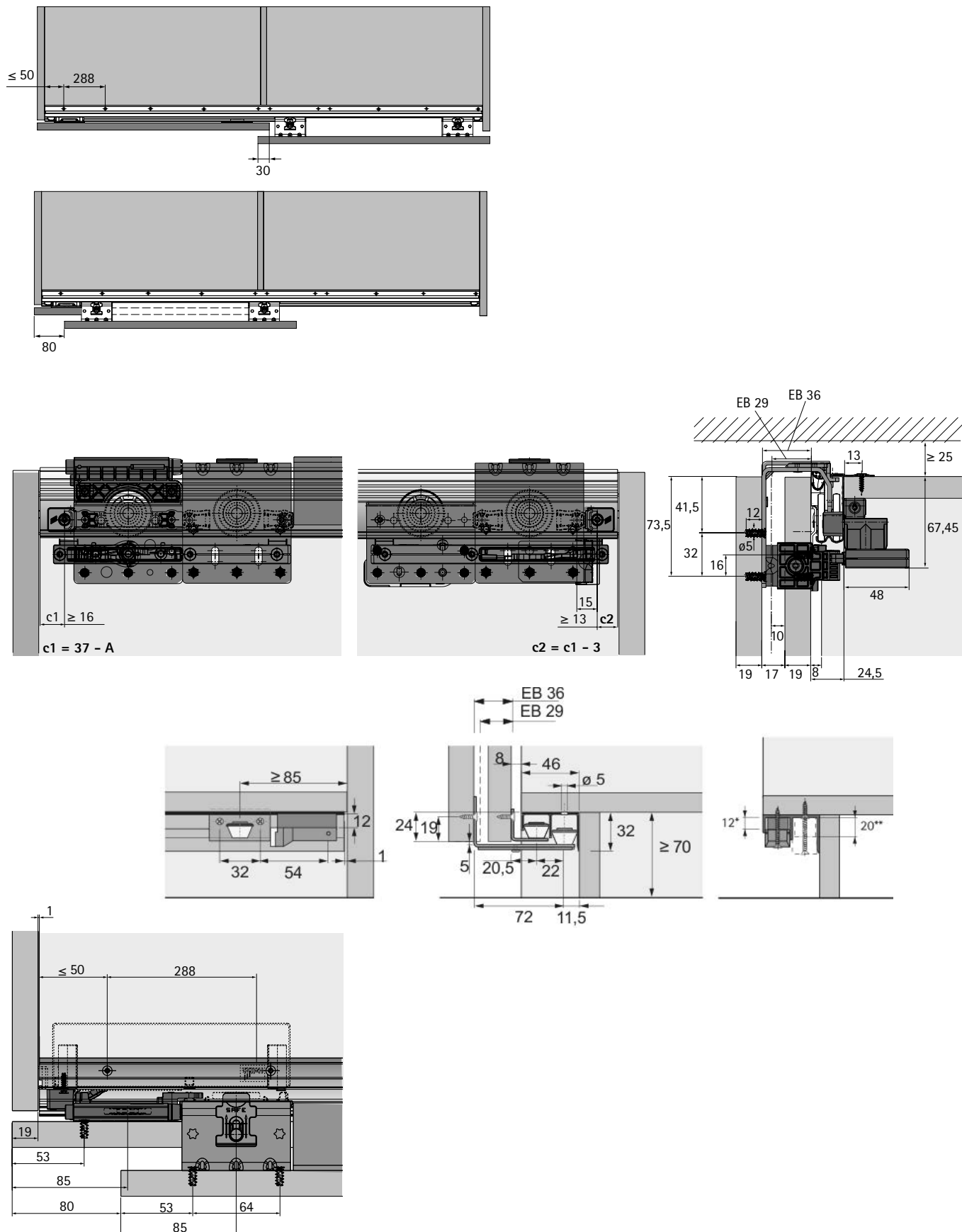

- ▶ TopLine 22
- ▶ Fitting situation

Technical drawings of the EB 36/29 door hinge system, showing various views and dimensions:

- Top View (Left):** Shows the hinge assembly with dimensions: ≤ 50 , 288, and 30.
- Top View (Right):** Shows the hinge assembly with dimensions: 80, EB 36, and EB 29.
- Side View (Left):** Shows the hinge assembly with dimensions: ≥ 85 , 12, 32, 54, and 1.
- Side View (Middle):** Shows the hinge assembly with dimensions: 24, 19, 8, 46, $\phi 5$, 32, ≥ 70 , 5, 20,5, 22, 72, and 11,5.
- Side View (Right):** Shows the hinge assembly with dimensions: 12*, 20**, and 30.
- Front View (Left):** Shows the hinge assembly with dimensions: $c1 \geq 16$ and $c1 = 37 - A$.
- Front View (Middle):** Shows the hinge assembly with dimensions: 350, F1, F2, 181, 53, 96, and 192.
- Front View (Right):** Shows the hinge assembly with dimensions: EB 29, EB 36, 13, 30, 41,5, 32, 16, 10, 19, 17, 19, 8, 24,5, 48, and 67,45.
- Bottom View (Left):** Shows the hinge assembly with dimensions: 1, ≤ 50 , 288, 19, 53, 85, 80, 53, 64, and 85.
- Bottom View (Right):** Shows the hinge assembly with dimensions: 350, F1, F2, 181, 53, 96, and 192.
- Detail View (Bottom):** Shows the hinge assembly with dimensions: F1, F2, and 181.

Formulas for F1 and F2:

$$F1 = \frac{\text{Profile length}}{2} + \frac{\text{Center door width}}{2} - 181$$

$$F2 = F1 + 192$$

Top running sliding door system

- ▶ TopLine 22
- ▶ Fitting situation

Support block

